

Section II.

TM 9-2320-272-34P-1

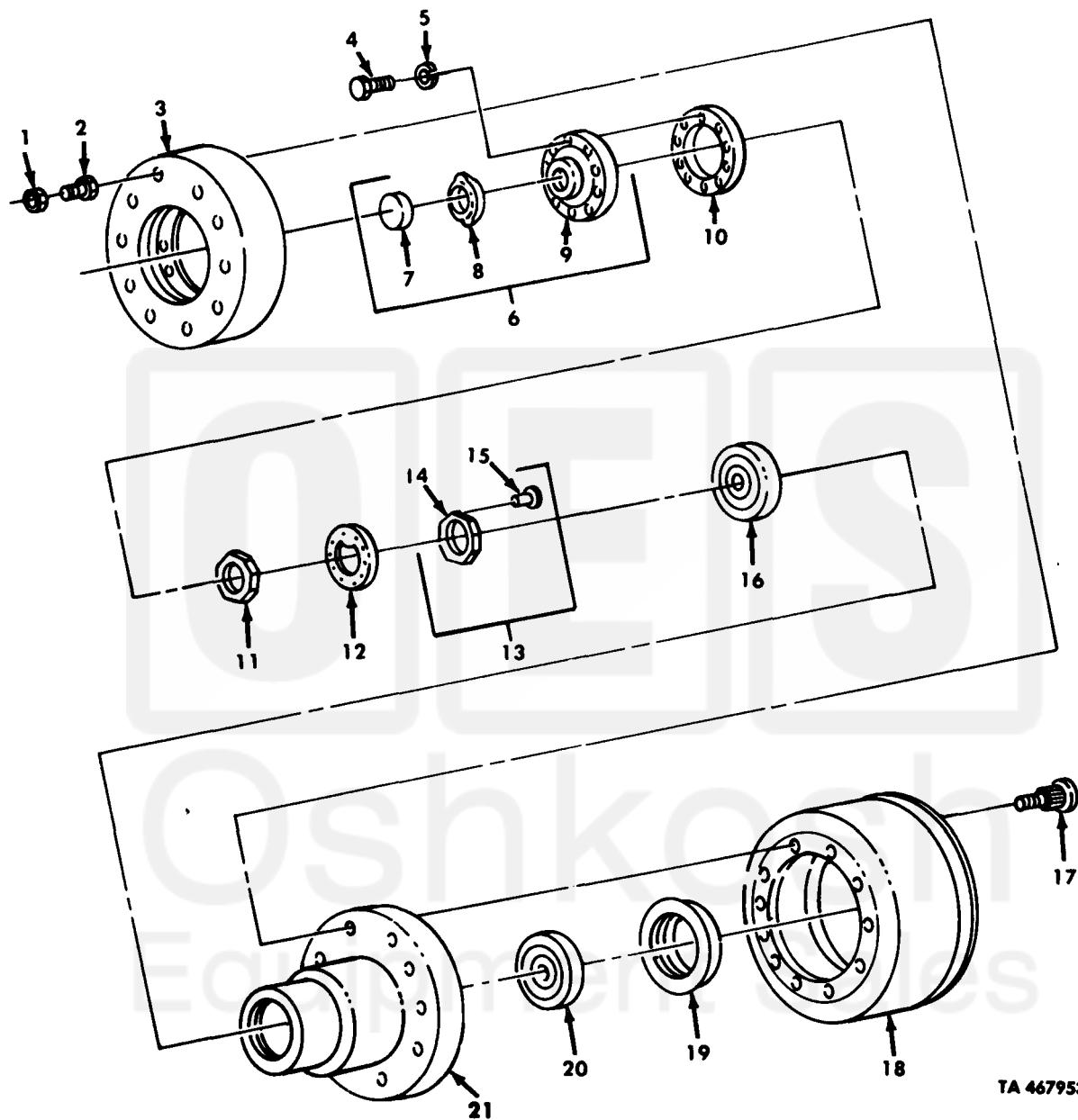

Figure 224. Front Wheel Hub and Drum Assembly.

Current part is item (17) on diagram. Available at www.oshkoshequipment.com

ILLUS. (a) FIG. NO.	(b) ITEM NO.	SMR CODE	NATIONAL STOCK NUMBER	PART NUMBER	FSCM	DESCRIPTION USABLE ON CODE	U/M	QTY INC IN UNIT
GROUP 1311 WHEEL ASSEMBLY FIG. 224 FRONT WHEEL HUB AND DRUM ASSEMBLY								
224	1	PAOZZ	5310-00-141-0447	10938443-1	19207	NUT, PLAIN, SINGLE WHEEL STUD LEFT UOC: DAA, DAB, DAC, DAD, DAE, DAF, DAG, DAH, DAJ, DAK, DAL, DAQ, DAR, DAW, DAX, V06, V07, V12, V13, V14, V15, V16, V17, V18, V19, V20, V21, V22, V24, V25	EA	10
224	1	PAOZZ	5310-00-480-7606	10938443-2	19207	NUT, PLAIN, SINGLE WHEEL STUD RIGHT UOC: DAA, DAB, DAC, DAD, DAE, DAF, DAG, DAH, DAJ, DAK, DAL, DAQ, DAR, DAW, DAX, V06, V07, V12, V13, V14, V15, V16, V17, V18, V19, V20, V21, V22, V24, V25	EA	10
224	1	PAOZZ	5310-00-176-6525	10938444-1	19207	NUT, PLAIN, SINGLE WHEEL STUD, LEFT UOC: DAV, V39	EA	10
224	1	PAOZZ	5310-00-176-6521	10938444-2	19207	NUT, PLAIN, SINGLE WHEEL STUD, RIGHT UOC: DAV, V39	EA	10
224	2	PAOZZ	2530-00-359-1162	MS53068-2	96906	NUT, CAP, DUAL WHEEL RIGHT UOC: DAV, V39	EA	10
224	2	PAOZZ	2530-00-693-1029	MS53068-1	96906	NUT, CAP, DUAL WHEEL LEFT UOC: DAV, V39	EA	10
224	3	PAOZZ	2530-00-741-1105	3280-B-1978	78500	ADAPTER, BRAKE DRUM UOC: DAV, V39	EA	2
224	4	PAOZZ	5306-00-182-9267	10896726	19207	BOLT, MACHINE	EA	20
224	5	PAOZZ	5310-00-584-5272	MS35338-48	96906	WASHER, LOCK	EA	20
224	6	PAOOO	2520-00-734-6991	7346991	19207	FLANGE, COMPANION	EA	2
224	7	PAOZZ	5340-00-734-6992	7346992	19207	PLUG, EXPANSION	EA	1
224	8	PAOZZ	5330-00-291-3273	MS29513-229	96906	PACKING, PREFORMED	EA	1
224	9	XAOZZ		8758278	19207	FLANGE ASSEMBLY	EA	1
224	10	PAOZZ	5330-00-734-6993	7979275	19207	GASKET	EA	2
224	11	PAOZZ	5310-00-353-2427	7979263	19207	NUT, PLAIN	EA	2
224	12	PAOZZ	5310-00-700-7089	5139123	19207	WASHER, KEY	EA	2
224	13	PAOZZ	5310-00-374-0836	7979308	19207	NUT, PLAIN	EA	2
224	14	XAOZZ		7979309	19207	NUT, OUTER WHEEL BEARING	EA	1
224	15	XAOZZ		7979310	19207	PIN, ADJUSTMENT	EA	1
224	16	PAOZZ	3110-00-100-4223	MS19081-181	96906	BEARING, ROLLER OUTER	EA	2
224	17	PAOZZ	5307-01-142-4783	20X-1529	78500	STUD LEFT FRONT WHEEL UOC: DAV, V39	EA	10
224	17	PAOZZ	5307-01-142-4784	20X-1528	78500	STUD RIGHT FRONT WHEEL UOC: DAV, V39	EA	10
224	17	PAOZZ	5307-01-132-8273	20X-1337X	78500	STUD, LEFT FRONT WHEEL UOC: DAA, DAB, DAC, DAD, DAE, DAF, DAG, DAH, DAJ, DAK, DAL, DAQ, DAR, DAW, DAX, V06, V17, V12, V13, V14, V15, V16, V17, V18, V19, V20, V21, V22, V24, V25	EA	10
224	17	PAOZZ	5307-01-132-8274	20X-1336	78500	STUD, RIGHT FRONT WHEEL UOC: DAA, DAB, DAC, DAD, DAE, DAF, DAG, DAH, DAJ, DAK, DAL, DAQ, DAR, DAW, DAX, V06, V07, V12, V13, V14, V15, V16, V17, V18, V19, V20, V21, V22, V24, V25	EA	10
224	18	PAOFF	2530-01-134-6570	3219-C-4345	78500	DRUM, BRAKE FRONT	EA	2
224	19	PAOZZ	5330-00-740-9550	7979349	19207	SEAL, PLAIN ENCASED	EA	2
224	20	PAOZZ	3110-00-100-4220	MS19081-137	96906	BEARING, ROLLER	EA	2
224	21	PAOZZ	3040-01-139-1611	A333-T-2334	78500	HUB, FRONT WHEEL	EA	2
END OF FIGURE								

Current part is item (17) on diagram. Available at www.oshkoshequipment.com